

Courtesy Review for Variance

29 W 140 Batavia Rd

Melody and James Burke

We would like to potentially subdivide the lot into three lots. We are requesting a variance in lot width to approximately 89 feet instead of the required 90 feet. The resulting lots would still be over $\frac{3}{4}$ of an acre each.

City water is on this side of Batavia Rd. and sewer is on the opposite side. There are 3 sewer stubs installed across Batavia Rd. to the property.

CHAIN LINK FENCE ONLINE

LOT 29

DUPAGE RIVER
S59°50'35"E
293.44' M

WEST LINE OF THE EAST HALF
LOT 28 AS MONUMENTED
AND OCCUPIED

SET 5/8 REBAR ON
55' OFFSET

EDGE WATER

LOT 28

RIVER HIGHLANDS
REC. JAN 5, 1910
DOC# 99196

461.06 M TO CL BATAVIA ROAD
N02°52'34"E
425.21' M

WOOD DECKS

END
4.2'

SET 5/
75' OF

148.29'

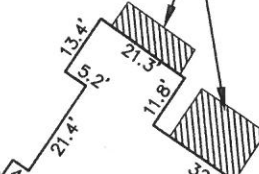

ONE STORY
FRAME HOUSE

46.00'

CONC. WALK

CHAIN I
1.8' EA'

ONE STORY
FRAME GARAGE



SHED

87.07'

ASPHALT DRIVE

117.12'

FRAME BARN

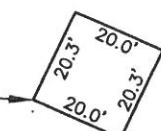

CHAIN LINK FENCE
0.5' EAST

FOUND IRON PIPE
AT CORNER

70.44'

81.31'

240.42'

148.26'

148.26'

266.94' M
S64°07'16"E

SOUTH LINE LOT 28

BATAVIA 66' ROAD

SET 5/8 REBAR
AT CORNER

395.32' M
N5°03'49"E
430.62' M TO CL BATAVIA ROAD
(431.3')

EAST LINE LOT 28

CHAIN LINK F
0.76' WEST